

Appendix C

Agency Correspondence

THIS PAGE INTENTIONALLY LEFT BLANK



JENNIFER M. GRANHOLM
GOVERNOR

STATE OF MICHIGAN
DEPARTMENT OF ENVIRONMENTAL QUALITY
GRAND RAPIDS DISTRICT OFFICE



STEVEN E. CHESTER
DIRECTOR

December 11, 2009

Mr. Taiwo Jaiyeoba
Director of Planning and Program Development,
300 Ellsworth Avenue, SW
Grand Rapids, MI 49506

Dear Mr. Jaiyeoba:

SUBJECT: Floodplain Service Number: 09-41-0028-FP
T 07N, R 11W, City of Grand Rapids, Kent County, Grand River

Your proposed project is to install bus stop benches, partially enclosed (but not fully enclosed), according to the attached design and locations. Based on this information, no permit will be required under the State's Floodplain Regulatory Authority found in Part 31, Water Resources Protection, of the Natural Resources and Environmental Protection Act, 1994 PA 451, as amended (Part 31) for the installation of these bus stops. A permit may be required, however, for any additional work such as filling or grading in regulated areas.

Generally, any occupation, filling, grading below the 100-year floodplain elevation requires a permit from the Land and Water Management Division (LWMD) under Part 31. Compensating cut for more than 300 cubic yards of fill placed in the floodplain must be provided.

In general, construction and fill may be permitted in portions of the floodplain that are not floodway, provided local ordinances and building standards are met. Floodways are the channel of the stream or drain and those portions of the floodplain adjoining the channel that are reasonably required to carry and discharge the 100-year flood. These are generally the areas of moving water during a flood. Work activity in the floodway will normally require an engineering analysis to verify that the proposal does not increase the floodplain elevation on upstream properties. Residential construction is prohibited in the floodway portion of the floodplain.

The Michigan Residential Building Code requires that the lowest floor be elevated at least one foot above the design flood level. Basement floors that are below grade on all four sides shall be elevated to or above the design flood level (normally the 100-year elevation). Non-residential structures may be elevated or dry floodproofed. Enclosed space below the 100-year floodplain elevation, such as a crawl space, must be designed to automatically equalize hydrostatic forces on exterior walls.

The City of Grand Rapids participates in the National Flood Insurance Program (NFIP). Proper enforcement of the building code standards is a prerequisite of the community's participation in the NFIP. Additional local requirements may also apply and be more restrictive. In the NFIP communities, flood insurance must be purchased as a condition of obtaining a federally insured mortgage in federally identified 100-year floodplain areas. Insurance rates can be very high for new construction if the lowest floor elevation standards are not met.

December 11, 2009

No review has been performed as part of this service to determine whether wetlands exist at this subject site. Wetlands are regulated under the authority of Part 303, Wetlands Protection, of the NREPA. The existence of wetlands may restrict the development on site. If you are unsure of the presence of wetlands, it is recommended that you contact the LWMD concerning the Wetlands Identification Program (WIP) or engage a private wetland consultant. For more information regarding the WIP, please contact Mr. Todd Losee, Inland Lakes and Wetlands Unit, at 517-335-3457. If the project will impact wetlands, please contact Bob Day of this office at 61-356-0030 for a permit application and information. The permit application may also be found at the following internet address:
www.michigan.gov/jointpermit.

This letter does not obviate the need for any other State, Federal, or local permits which may be required by law. If you have any further questions regarding the floodplain requirements, please feel free to contact me.

Sincerely,

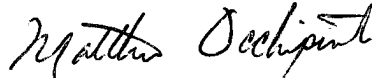

Matthew Occhipinti, P.E.
District Floodplain Engineer
Land and Water Management Division
616-356-0207

Enclosure

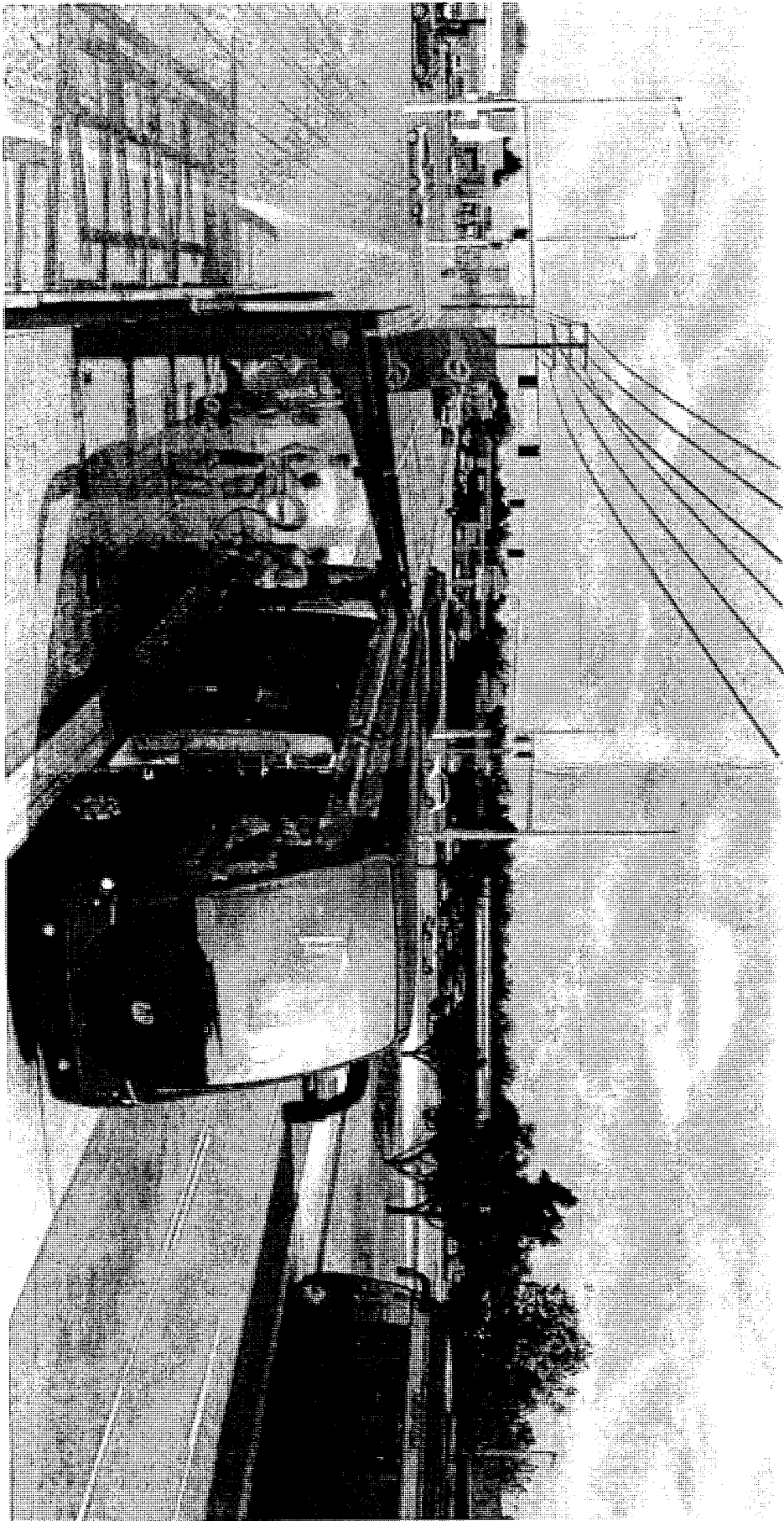

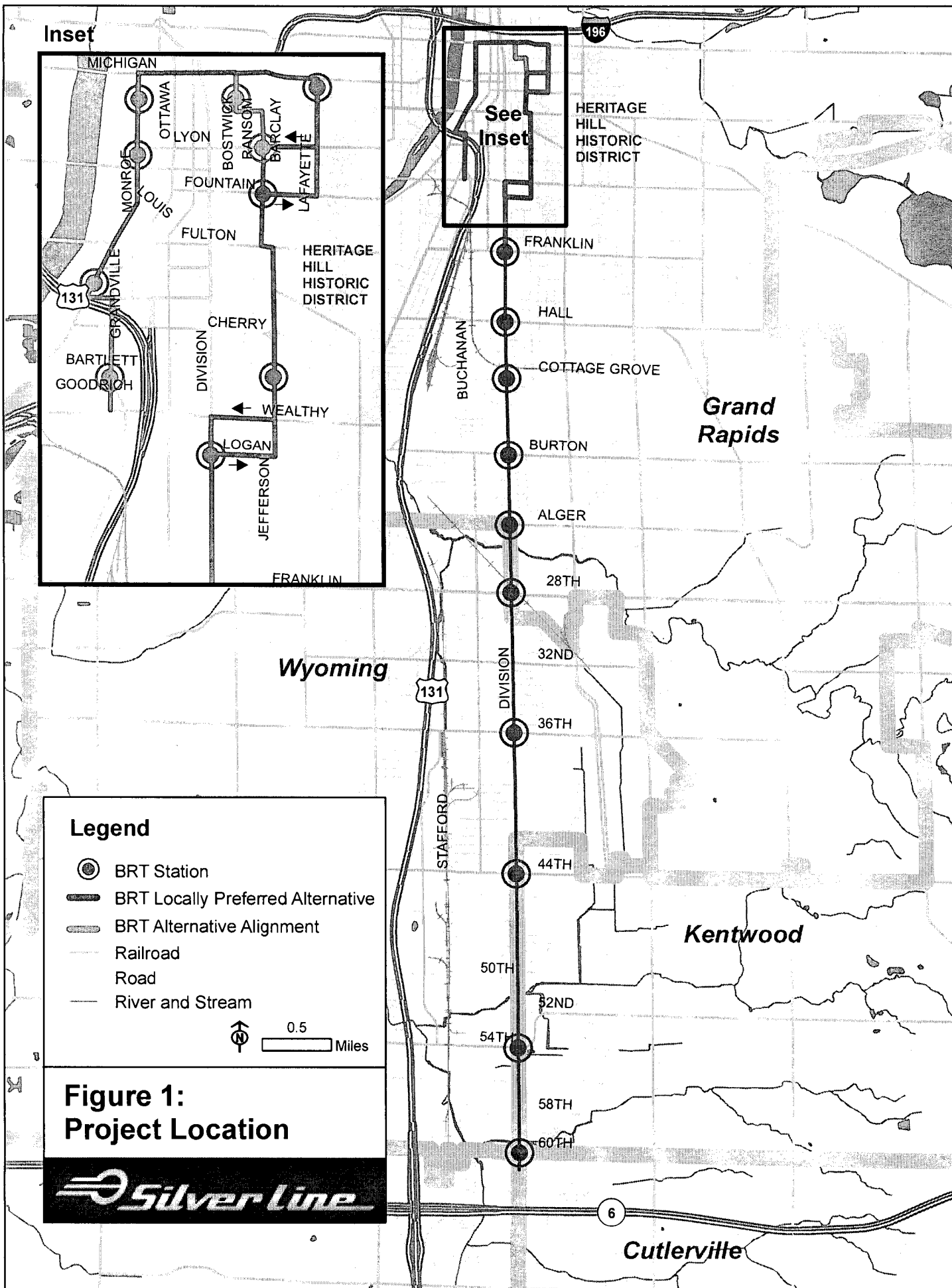

09-460028-FP

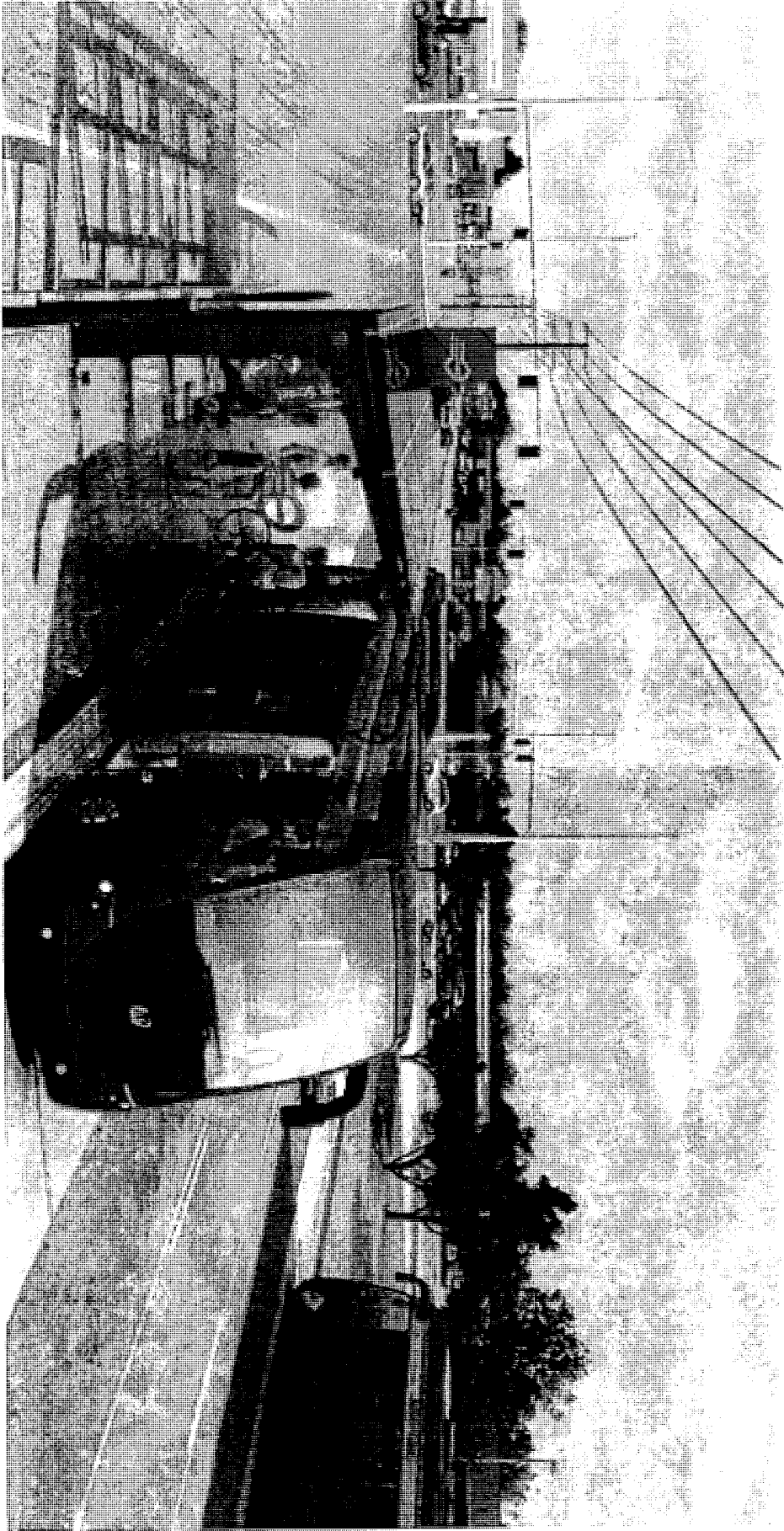

THIS PAGE INTENTIONALLY LEFT BLANK

Ott, Steven

From: Taiwo Jaiyeoba [TJaiyeoba@ridetherapid.org]
Sent: Wednesday, July 08, 2009 2:49 PM
To: Selover, Timothy; Ott, Steven; Mukherjee, Sharmila
Subject: FW: Grand Rapids Silver Line BRT Project

FYI

From: Occhipinti, Matthew (DEQ) [mailto:OCCHIPINTIM@michigan.gov]
Sent: Wednesday, July 08, 2009 2:48 PM
To: Taiwo Jaiyeoba
Subject: RE: Grand Rapids Silver Line BRT Project

We would not require a floodplain permit for these bus stops, as they're not enclosed and don't involve any filling in the floodplain.

Matthew Occhipinti, P.E.
Grand Rapids District Engineer
Land and Water Management Division
350 Ottawa Ave, NW, Grand Rapids, MI 49503
Ph: 616-356-0207 Fax: 616-356-0202
www.michigan.gov/deq

From: Taiwo Jaiyeoba [mailto:TJaiyeoba@ridetherapid.org]
Sent: Monday, June 08, 2009 11:04 AM
To: Occhipinti, Matthew (DEQ)
Cc: Saldivia, Luis (DEQ)
Subject: RE: Grand Rapids Silver Line BRT Project

We do not have fully developed plans (and certainly no cross-sections) for the BRT station since the environmental assessment has got to be finalized first before we can engage in advanced design work. However, the link below will give you an idea what the station is envisioned to look like once done.

<http://www.nc3d.com/download-files/grand-rapids-brt/index.php>

The link will open to a visual simulation of the BRT system and how it is supposed to run and stop at each station. You will notice the design of the enhanced bus stations. They are not enclosed, more like high-end bus shelters designed to look like train stations. I hope this answers your questions.

Thank you.

From: Occhipinti, Matthew (DEQ) [mailto:OCCHIPINTIM@michigan.gov]
Sent: Friday, June 05, 2009 3:11 PM
To: Taiwo Jaiyeoba
Cc: Saldivia, Luis (DEQ)
Subject: RE: Grand Rapids Silver Line BRT Project

Can you send a plan (plan view and cross-section) for the bus stations? ... showing what is generally existing and what how you're proposing to modify them?

If they're not fully enclosed, they would not be required to be elevated above the 100-year floodplain. Depending on what exactly you're doing to them they may still need a permit if they're below flood elevation. If you have topo showing that they are above the floodplain, you can submit it and we would be happy to send a letter of no floodplain authority.
Matt

Matthew Occhipinti, P.E.

Grand Rapids District Engineer
Land and Water Management Division
350 Ottawa Ave, NW, Grand Rapids, MI 49503
Ph: 616-356-0207 Fax: 616-356-0202
www.michigan.gov/deq

From: Taiwo Jaiyeoba [mailto:TJaiyeoba@ridetherapid.org]
Sent: Friday, June 05, 2009 3:01 PM
To: Occhipinti, Matthew (DEQ)
Cc: twilliamsn@aecom.com; Conrad Venema; ott@pbworld.com
Subject: RE: Grand Rapids Silver Line BRT Project

Thanks, Matthew, for your response.

We are not proposing to fill, grade, construct or occupy any portion of the corridor below the 100-year floodplain elevation.

The stations will not be substantial building but an enhancement of the bus stations we currently have. This means we have a 10-inch elevated platform, fare dispensing equipment, seating place, kind of an improved patio-like element.

We are currently going through our Environmental Assessment. Please let me know if you need additional information. We will still a letter from your offices confirming that our project does not require the obtaining of a floodplain permit.

Thanks, again.

-----Original Message-----

From: Occhipinti, Matthew (DEQ) [mailto:OCCHIPINTIM@michigan.gov]
Sent: Thu 6/4/2009 4:31 PM
To: Taiwo Jaiyeoba
Subject: RE: Grand Rapids Silver Line BRT Project

The flood insurance rate map is strictly for insurance purposes. If you are proposing filling, grading, construction, or occupation below the 100-year floodplain elevation, you'll need to obtain a floodplain permit.

Looking at the map you provided, the stations along Monroe and at 60th street could possibly be below the floodplain. I would want more detail on these proposed stations... If they're simply a bench with a roof over them, they're not going to be any big deal at all. If they are actual buildings, they will need to be elevated 1 foot above the 100-year floodplain elevation.

For initial elevation info, the City has access to REGIS contours. These aren't completely accurate, but they're a very good start.

Thanks,
Matt

Matthew Occhipinti, P.E.

Grand Rapids District Engineer

Land and Water Management Division

350 Ottawa Ave, NW, Grand Rapids, MI 49503

Ph: 616-356-0207 Fax: 616-356-0202

www.michigan.gov/deq

From: Taiwo Jaiyeoba [<mailto:TJaiyeoba@ridetherapid.org>]
Sent: Friday, May 22, 2009 11:40 AM
To: Occhipinti, Matthew (DEQ)
Cc: Conrad Venema
Subject: RE: Grand Rapids Silver Line BRT Project

Hello:

I have attached a copy of the letter sent to USCOE initially as well as the approved project alignment map overlaid on the floodplain map. Please let me know if you have other questions.

Thank you.

From: Occhipinti, Matthew (DEQ) [<mailto:OCCHIPINTIM@michigan.gov>]
Sent: Friday, May 15, 2009 3:00 PM
To: Taiwo Jaiyeoba
Subject: RE: Grand Rapids Silver Line BRT Project

I would need a detailed location map showing where the work is being proposed. I would also need to know exactly what is being proposed at the location(s).

Thanks,
Matt

Matthew Occhipinti, P.E.

Grand Rapids District Engineer

Land and Water Management Division

350 Ottawa Ave, NW, Grand Rapids, MI 49503

Ph: 616-356-0207 Fax: 616-356-0202

www.michigan.gov/deq

From: Taiwo Jaiyeoba [<mailto:TJaiyeoba@ridetherapid.org>]
Sent: Friday, May 08, 2009 9:54 AM
To: Saldivia, Luis (DEQ); Occhipinti, Matthew (DEQ)
Cc: Ott, Steven; Mukherjee, Sharmila
Subject: Grand Rapids Silver Line BRT Project

Hello. I received the attached letter from Mr. Paul Allarding yesterday regarding the subject matter and per the details of the letter, I am forwarding to both of you requesting assistance in determining:

(a) whether or not an MDEQ permit is required for the project, and if so, what are the requirements and,

(b) whether or not a State floodplain permit is applicable to the project, prior to a future construction.

Any prompt assistance you are able to offer will be greatly appreciated. Should you prefer, I can schedule an appointment to meet with both of you to discuss the project and requirements for any needed permits. We are currently conducting an Environmental Assessment for the project per Federal NEPA requirements and I would like to coordinate efforts on all fronts. Thanks.

Taiwo "Ty" Jaiyeoba

Director of Planning & Program Development, The Rapid

300 Ellsworth Avenue SW

Grand Rapids, MI 49506-4005

tel: 616.456.7514 . fax: 616.456.1941

tjaiyeoba@ridetherapid.org

"It's not the size of the dog in the fight, it's the size of the fight in the dog" - Mark Twain

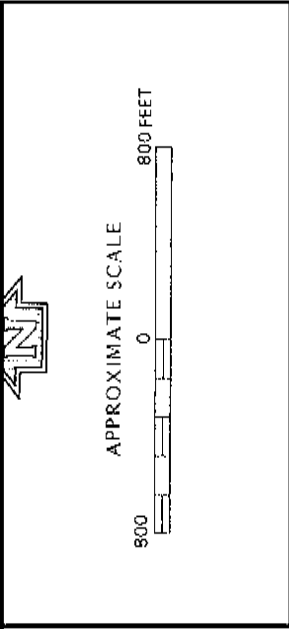

NATIONAL FLOOD INSURANCE PROGRAM

FIRM FLOOD INSURANCE RATE MAP

CITY OF GRAND RAPIDS, MICHIGAN KENT COUNTY

PANEL 15 OF 25
(SEE MAP INDEX FOR PANELS NOT PRINTED)

COMMUNITY PANEL NUMBER 260106 0015 C

MAP REVISED: NOVEMBER 5, 1982



Federal Emergency Management Agency

This is an official copy of a portion of the above referenced flood map. It was extracted using F-MI-CR-Line. This map does not reflect changes or amendments which may have been made subsequent to the date on the title block. For the latest product information about National Flood Insurance Program flood maps, check the FEMA Flood Map Store at www.msc.fema.gov

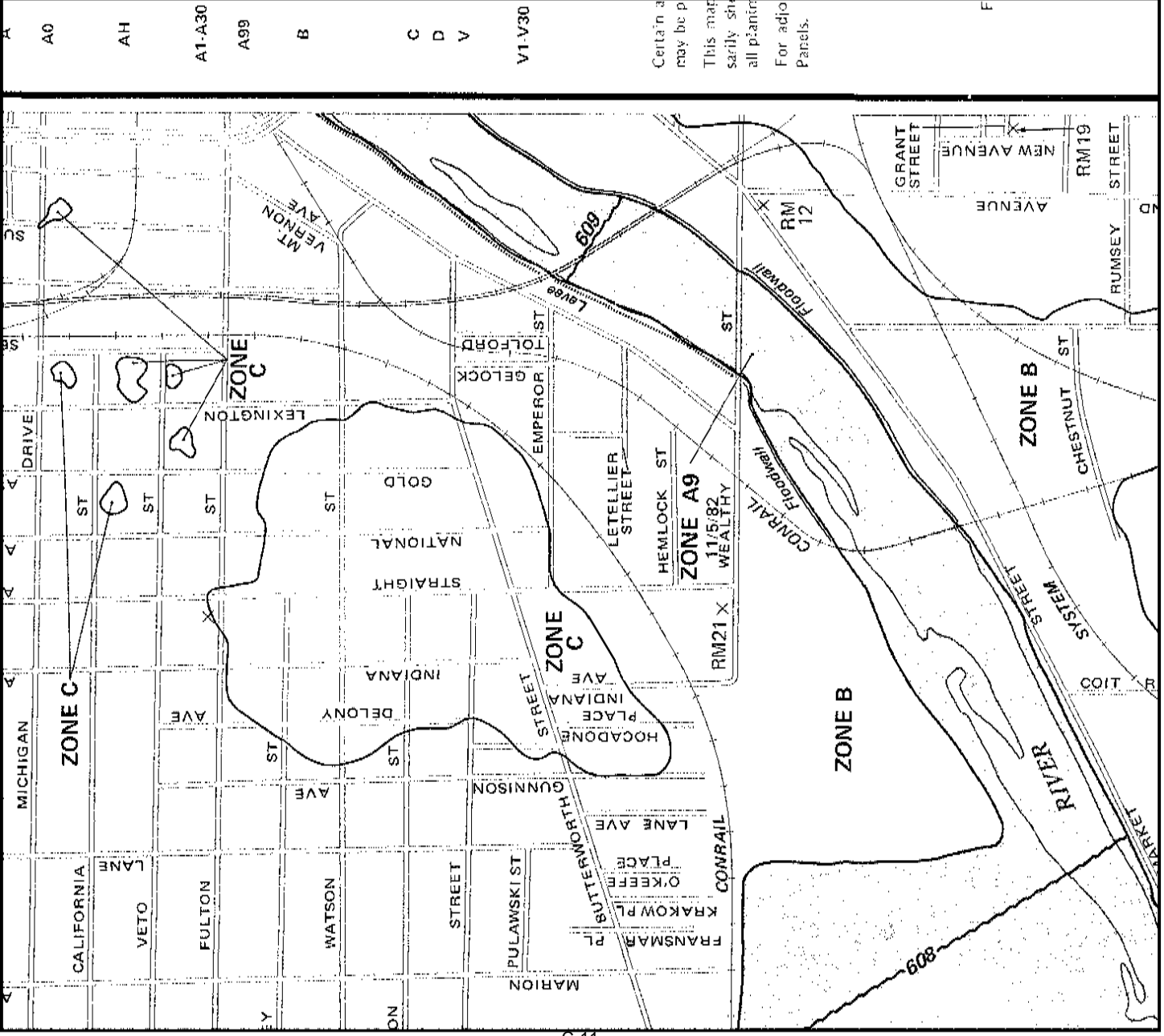

Certain areas may be partially shown on adjacent panels. This map is for planning purposes only. For adjacent panels, see map index.



NATIONAL FLOOD INSURANCE PROGRAM

FIRM FLOOD INSURANCE RATE MAP

CITY OF
GRAND RAPIDS,
MICHIGAN
KENT COUNTY

PANEL 20 OF 25
(SEE MAP INDEX FOR PANELS NOT PRINTED)

COMMUNITY-PANEL NUMBER
260106 0020 C

MAP REVISED:
NOVEMBER 5, 1982



Federal Emergency Management Agency

SEE INSET ON PANEL 260106 0020 C

This is an official copy of a portion of the above referenced flood map. It was extracted using F-M-I-C on-line. This map does not reflect changes or amendments which may have been made subsequent to the date on the title block. For the latest product information about National Flood Insurance Program flood maps, check the FEMA Flood Map Store at www.msc.fema.gov

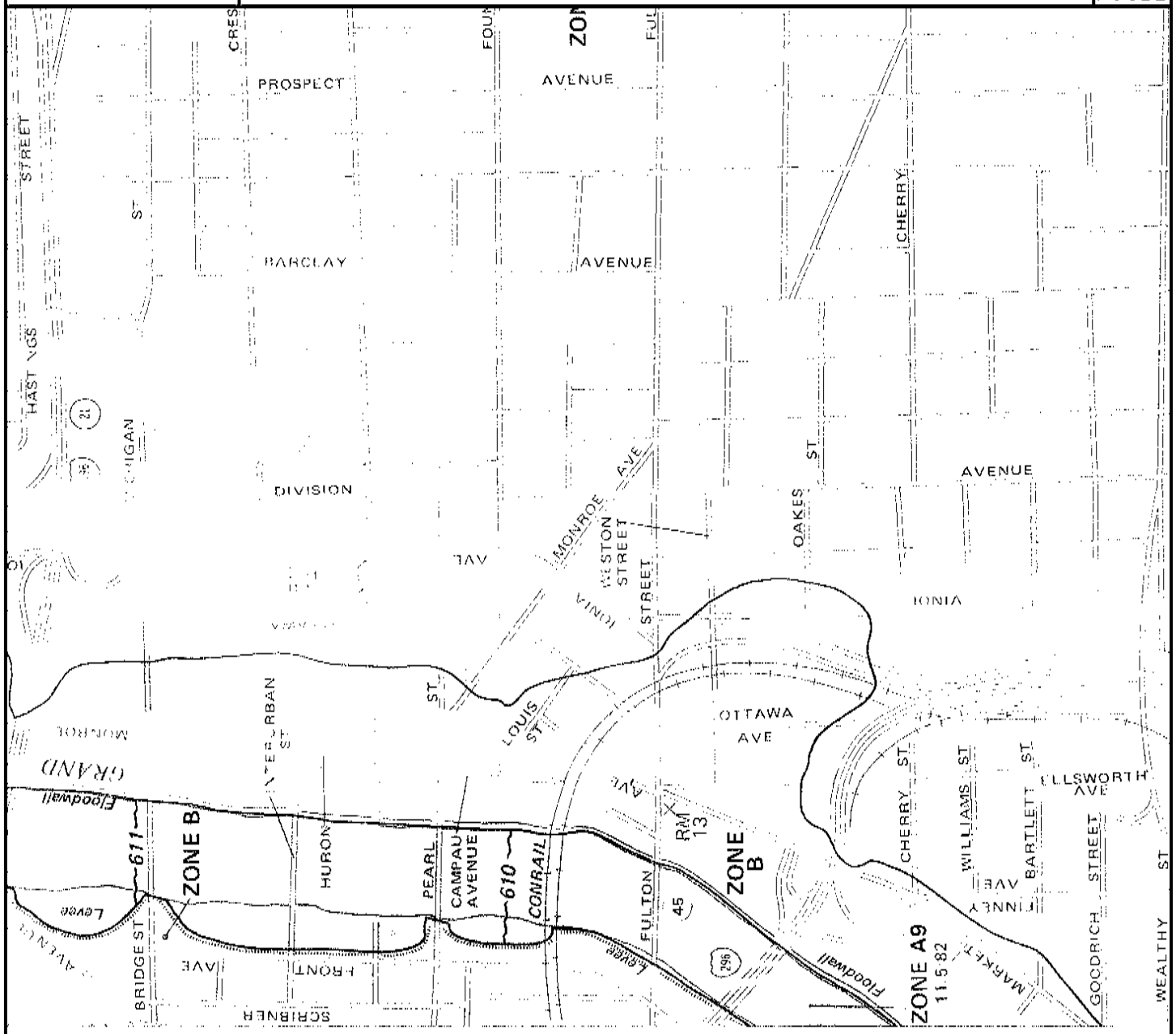

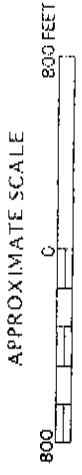

NATIONAL FLOOD INSURANCE PROGRAM

FIRM
FLOOD INSURANCE RATE MAP

CITY OF
**GRAND RAPIDS,
MICHIGAN**
KENT COUNTY

PANEL 25 OF 25
(SEE MAP INDEX FOR PANELS NOT PRINTED)

COMMUNITY-PANEL NUMBER
260106-0025 C

MAP REVISED:
NOVEMBER 5, 1982



Federal Emergency Management Agency

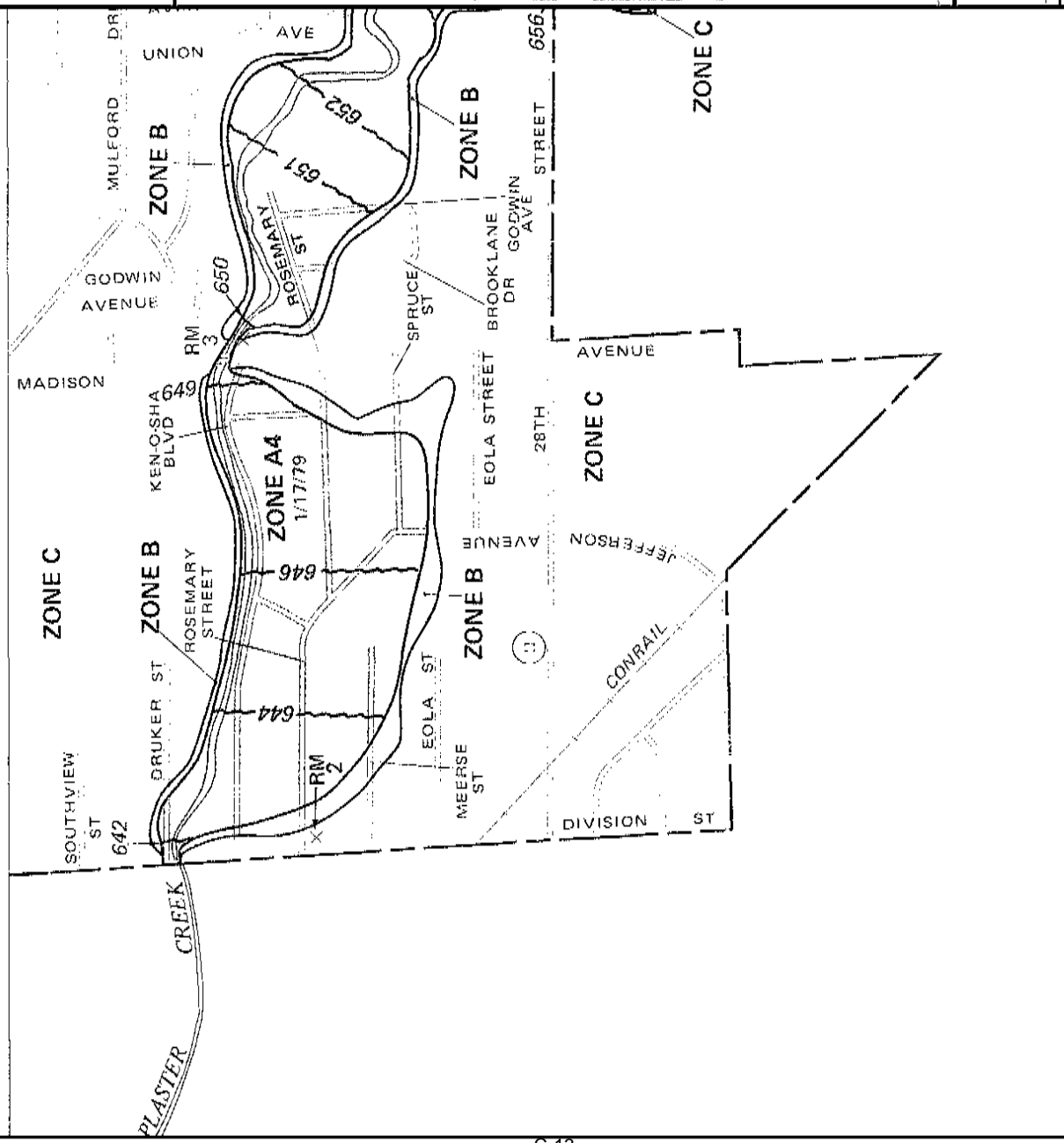

This is an official copy of a portion of the above referenced flood map. It was extracted using F-M-I™ On-Line. This map does not reflect changes or amendments which may have been made subsequent to the date on the title block. For the latest product information about National Flood Insurance Program flood maps, check the FEMA Flood Map Store at www.msc.fema.gov

THIS PAGE INTENTIONALLY LEFT BLANK